

A photograph of a traditional English gatehouse. The gatehouse has a tiled roof and a wooden sign above the archway. The sign contains a poem: "In Barnyard of Old English / who saw the world and the / land the world was / who saw the world was / who saw the world was / who saw the world was / who saw the world was / who saw the world was". The gatehouse is surrounded by a brick wall and a fence. A blue car is visible in the background.





hoppers'

hoppers'

Hoppers is in the midst of the Garden of England, just south of Tonbridge in the Kentish village of Five Oak Green.

The building started life centuries ago as four farm cottages, before becoming a village pub called the Rose and Crown. The medieval beams, low ceilings, and sloping floors upstairs can still be seen. Each September thousands of East Londoners would go down to Kent to help pick the hops. The Church in East End of London bought the house to care for them. It was renamed The Little Hoppers Hospital and belongs to a charitable company called The Red House, Stepney.

The house was renovated, in the 1980's, as hop farming declined, as a place where groups might go for a few days to find peace and quiet away from London. Now called Hoppers it is well used as a self-catering center for parish and family groups. The small Management Committee maintains a constant program of improvements.

ACCOMMODATION

Hoppers consist of two houses connected by a Kitchen/Dining Room. The main house (older building) has 13 beds, plus 2 extra mattresses. The ground floor is fully accessible by wheelchair (including one bedroom). The cottage (newer building) has 9 beds (1 is a double) plus 3 extra mattresses. For babies and children there are 2 travel cots (no linen), 2 highchairs and a baby bath, please bring your own stair gate if needed.

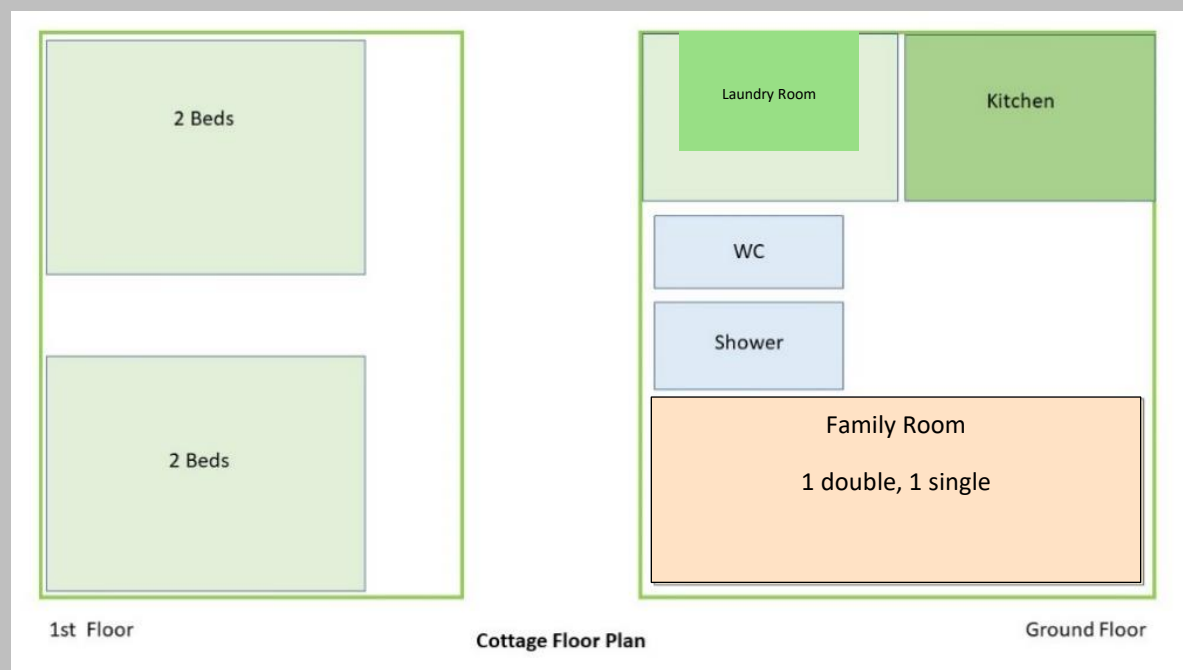
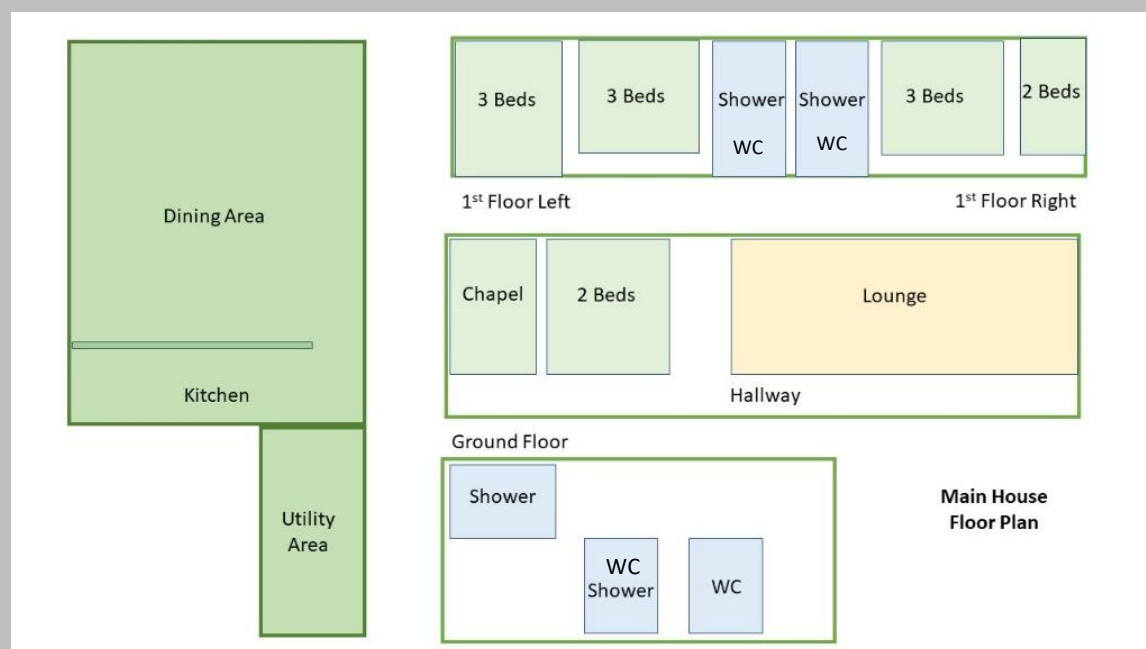

WHAT TO BRING

The kitchen is fully equipped for self-catering, with a range cooker, microwave, dishwasher, fridge and freezer, we also have a filter coffee machine and a Tassimo coffee pod machine. We do not provide washing up liquid, cloths, dustbin bags or dishwasher tablets; but toilet paper is provided.

All beds have two pillows and a blanket; however, you will need to bring your own bed linen.

A bed linen service is available by prior arrangement from Susannah Strawson – this includes pillowcases, a fitted sheet, duvet and cover and a bath towel at £10 per person. For enquiries regarding this service please contact Susannah directly at susannah.strawson@hotmail.com

Asthma sufferers are advised take their medication as the main house (older building) is often dusty.

CARETAKERS

The Hoppers caretakers, who live nearby, are Richard & Susannah Strawson, they can be contacted in the event of an emergency. Mobile: 07851 425661/07971 153513

Email: susannah.strawson@hotmail.com

ACCESS

Please contact Susannah prior to your stay for instructions on how to gain access to Hoppers. Keys to the inside doors at Hoppers are located on the door frames. All Keys should be returned before you leave.

DIRECTIONS

By Road

Postcode for navigation is TN12 6RL. Nearby railway stations are Paddock Wood and Tonbridge.

Car Parking

A maximum of 6-8 cars can be parked in the forecourt. Check the height before attempting to drive minibuses under the arch. Please do not park on the pavement outside the gates but use the recreation ground car park, Falmouth Place. It is signposted, Community Centre/Allotments. It is advisable for cars to enter Hoppers entrance from the right. Once in the front courtyard please take care to avoid hitting the supporting pillars.

SHOPPING

Most supermarkets offer an online delivery service to Hoppers.

Address for delivery: Hoppers, Five Oak Green Road, Five Oak Green, Tonbridge, Kent, TN12 6RL.

Five Oak Green: Post Office and One Stop are open 6.30am-10pm Mon-Sat, 8am-10pm Sun.

Tonbridge: Sainsburys, Waitrose, Iceland and Aldi.

Paddock Wood: Waitrose, Tesco Express.

MEDICAL EMERGENCIES

Woodlands Health Centre, Allington Road, Paddock Wood. ☎ 01892 833331.

Tunbridge Wells Hospital, Pembury TN2 4QJ ☎ 01892 823535.

CHURCHES

Details of services are in the parish magazine. The Revds. Jeremy & Pamela Ive can be contacted at the Vicarage in Sychem Lane. ☎ 01892 836653. Other churches can be found on www.findachurch.com

PLACES TO VISIT

Nearby places to visit include Tonbridge Castle, Bewl Water, Leeds Castle, Hever Castle, The Hop Farm and the villages of Brenchley and Hadlow.

All Saints Tudeley Parish Church contains stained glass windows by Marc Chagall.

Thomas a Becket Capel features 12th century wall paintings as well as the story of Thomas a Becket preaching under its Yew tree. Both Tudeley and Capel can be reached by public footpaths.

HOUSEKEEPING

Entry to the main house is via the kitchen door off the rear courtyard: To avoid bringing dirt in and letting heat out, the front doors should only be used as fire exits.

- Night storage heaters in the main house will be on, except during the summer months. Remember they will have difficulty reheating the house if external doors are left open.
- Heaters in the cottage are not cheap rate. They can be turned on at the wall when required, please make sure these are turned off when you leave.
- The four immersion heaters will also be on and should not need to be touched. The cottage immersion switch is in the airing cupboard, at the top of the stairs.
- Both upstairs showers in the main house (above lounge) run off the same immersion which may need time to reheat. The immersion switch for these showers can be accidentally turned off, as the switch is outside, by the light switch. The red light for this switch shows it is turned on.
- The switch for hot water in the kitchen is located just inside the galley on the right-hand side.
- The switch for the lobby showers (downstairs) is in the airing cupboard, also in the lobby.
- The water supply is metered, so do not leave taps running.
- Some of the neighbouring homes have small children. External noise should be kept to a minimum after 10.00pm.

- There is a smart TV in the main house lounge, please return the remote control on the beam above the TV set.
- There is an Alexa echo dot in the kitchen of the main house.
- The fuse boxes are labelled; main house - in the Chapel and kitchen and one in the cottage hallway.
- There is Wifi at Hoppers, although the quality can be poor in the village. The sign in is 'guest'.

WASTE DISPOSAL

The Local Council defines four categories of waste/recycling. These should be emptied to the appropriate wheelie bins, which are located through the side gate to the right of the Chapel window.

CATEGORIES MAY BE DIFFERENT FROM WHAT YOU ARE USED TO AT HOME

Food: Green kitchen caddy with **compostable** bags provided, Food, bones, eggshells, teabags & peelings – no plastic. Empty it into BLACK FOOD BIN outside the kitchen door.

General: Stainless steel bin in kitchen, please use black bin bag. Plastic bags & wrappers, nappies, waxy juice cartons, cloth, etc. Tie up and empty to GREEN wheelie bin (there are 3)

Paper: Paper, cardboard, magazines & catalogues – no napkins, tissues or kitchen towel. Empty it into GREEN BOX "PAPER AND CARDBOARD"

Tins, Glass, Plastics: Tins, cans, plastic bottles, glass bottles and jars – washed and squashed and emptied into BROWN wheelie bin. No cartons/cellophane/wrappers.

FIRE SAFETY

- The main house is largely made of wood. Special care should therefore be taken.
- Fire Safety Instructions are displayed throughout.
- The group leader is responsible for explaining them to everyone on arrival.
- Doors and windows should not be locked or obstructed.
- All external doors have a fire escape function, keys for these doors are located on each door frame.
- The building is not high up, so all windows are fire escapes.
- Smoking is not permitted in any of the buildings.
- There are smoke alarms in every room.
- If the smoke alarm accidentally goes off, it can be reset by pressing the black rubber button on the box at the far end of the Chapel; you may need to press it a couple of times!
- Dry powder extinguishers and fire blankets are strategically placed.

COMFORT AND SAFETY

Bedroom Heating: There are oil-filled radiators, which will heat the low-ceiling rooms very quickly. Please be mindful of the use and cost of energy and make sure they are switched off when you leave.

Night Storage Heaters [NSHs]: Have been set by the caretaker, please do not change the settings.

Heat Loss: One problem about NSHs is that if the heat is let out of the room there is no booster system to replace it. The simple solution, in the winter, is to ensure that doors are kept shut.

Drains: Ancient and narrow drains run under the lawn. It is unpleasant and expensive to have them cleared if they get blocked, please do not put excessive amounts of paper, sanitary items or nappies down the toilets. Do not put any fat down the sinks, please use the 'fat bucket' outside.

Low Beams: Care should be taken when at Hoppers due to the low beams in the main house.

Step: When the dining room was built 100 years ago the floor was laid slightly below that of the old house. This has resulted in there being a low step in the area of the toilets. please ensure people that they are aware of it.

First Aid: There is a basic first aid box in the kitchen drawer, but it is advisable to bring your own.

Cleaning: Two vacuum cleaners are in the cupboard under the stairs.

Attics: The attics are padlocked and out of bounds for safety reasons.

Garden: Please keep our garden tidy. For the convenience of smokers there is a designated smoking area complete with a wall mounted bin. There is a barbeque for the use of visitors, please don't attempt to move it as it is chained to the wall, please clean it properly. There is a table tennis table behind the cottage for the enjoyment of visitors, please put this back after use.

LEAVING CHECKLIST

- Designate someone to work through this list before you go!
- Please leave Hoppers' as clean as you found it.
- Return all items (bedding, kitchen equipment, heaters etc.) to where they belong.
- Each bed should have 2 pillows, 1 yellow blanket and 1 bedspread.
- Food should not be left behind and rubbish should be disposed of as indicated above.
- Make sure the dishwasher has been emptied.
- Take all your belongings with you. Lost property is kept for a month before disposal.
- Leave the electricity, water mains and night storage heaters switched on, but ensure all other appliances are switched off and taps are not left running. Close windows and doors.
- Sign the Visitors Book for future interest.

SUGGESTIONS & BREAKAGES

The Trustees would ask that you:

- Make helpful suggestions.
- Encourage the Management Committee.
- Report anything not working.
- Confess any breakages – you may be asked to pay for them depending on what they are.

We hope you enjoy your stay at Hoppers, please keep in touch with us on Facebook @hopperskent.



2024

hoppersbookings@gmail.com

www.hopperskent.org

Hoppers,
Five Oak Green Road,
Five Oak Green,
Kent
TN12 6RL
Charity Number 208940